

DYNAMIC HEAT GENERATOR – MODEL A1R1163/A2R1163

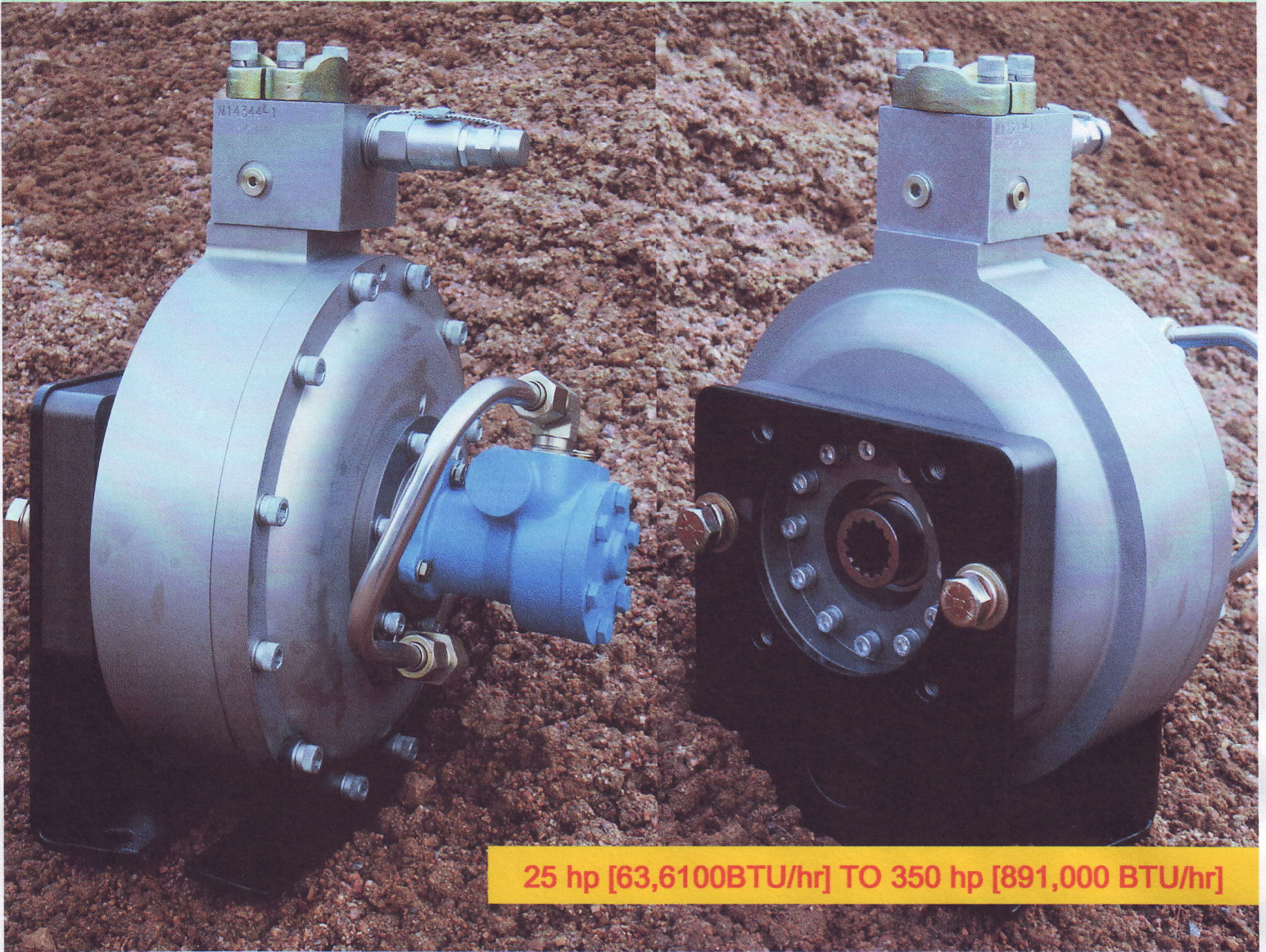

- PREHEAT AND WARM ENGINES
- HEAT TO VAPORIZE LIQUIFIED GASES
- HEAT OILS, FUELS AND LUBRICANTS
- HEAT BUILDINGS, SHELTERS, AND DECKS
- PREVENT WATER FREEZING IN TANKS
- WARM AND CIRCULATE POTABLE WATER
- DEICE VEHICLES AND AIRCRAFT
- BOIL WATER/DESTROY PATHOGENS
- HEAT COOKING AND WASH WATER
- WARM HYDRAULIC SYSTEMS
- COOK AND HEAT FOOD

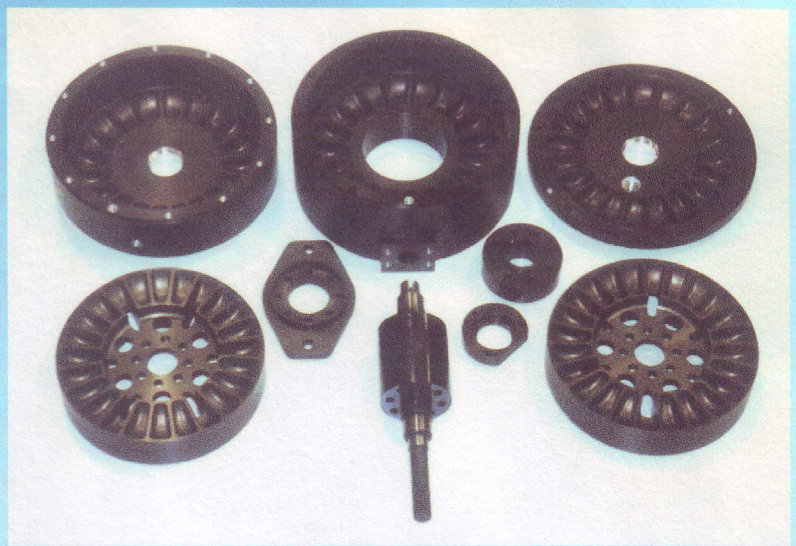

Simple and rugged characterizes the Island City DHG construction.. Monolithic CNC machined components are TYPE III anodized per MILSPEC for corrosion and erosion protect. Hard housing surface finish (85 Rockwell) is approved for potable water and food applications. Operating temperature range to 250 deg F [121 deg C] with higher operating temperature available upon application.

MODEL A2R1163 Single and Dual Rotor Heat Generators

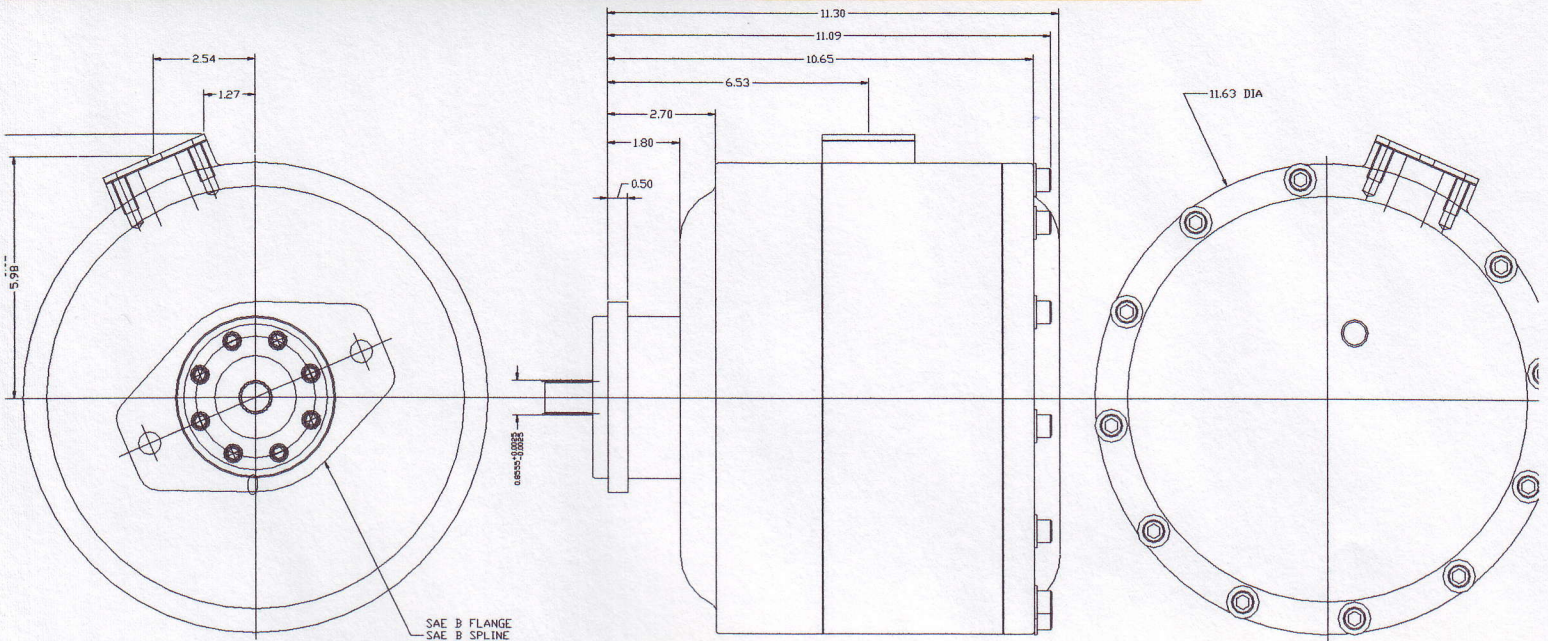

0 hp TO 350 hp [890,500 BTU/hr] INSTANTANEOUS HEAT

SINGLE ROTOR MODEL WEIGHS ONLY 30 lb

DUAL ROTOR MODEL WEIGHS ONLY 70 lb

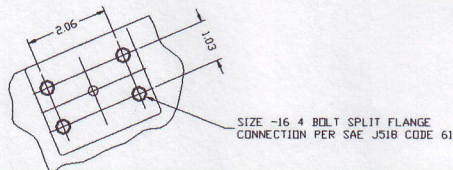

The ISLAND CITY Dynamic-Heat-Generator is a **MECHANICALLY DRIVEN** fluid heater. Only rotary shaft input is required to heat large fluid volumes rapidly and efficiently without a heat exchanger. **ORIGINALLY** developed to heat and maintain diesel engine temperature in arctic conditions the DHG is adaptable to many heating applications. Driven from engine PTO, electric motor, hydraulic drive or belt the DHG has one moving functional component requiring no regular service or consumables.

BASIC SPECIFICATIONS Model 1163

- Capacity:** Single Rotor: 250 hp [636,000 BTU/hr]
Dual Rotor: 350 hp [890,500 BTU/hr]
- Temp (max):** 250 deg F (Higher temperature available upon application)
- Drive:** SAE A, B, C, D or customer specified
- Heat Regulation:** Rotational Speed
Full Disconnect Clutch
Fluid Flow
Fluid Level Control
- Ports:** Inlet: #12 SAE Outlet: #16 Code 61 or customer specified
- Pressure (max)** 300 psi
- Options:** Integral Charge Pump
Full Disconnect Clutch
- Construction:** CNC Machined 6061 T6 Alloy
- Finish:** Hard Coat Type III Anodic Finish with sealer per MIL-A-8625F, meets requirements for food, ethylene glycol, and water service. (other housing materials and surface treatments available upon application)

Performance Curve Model 1163

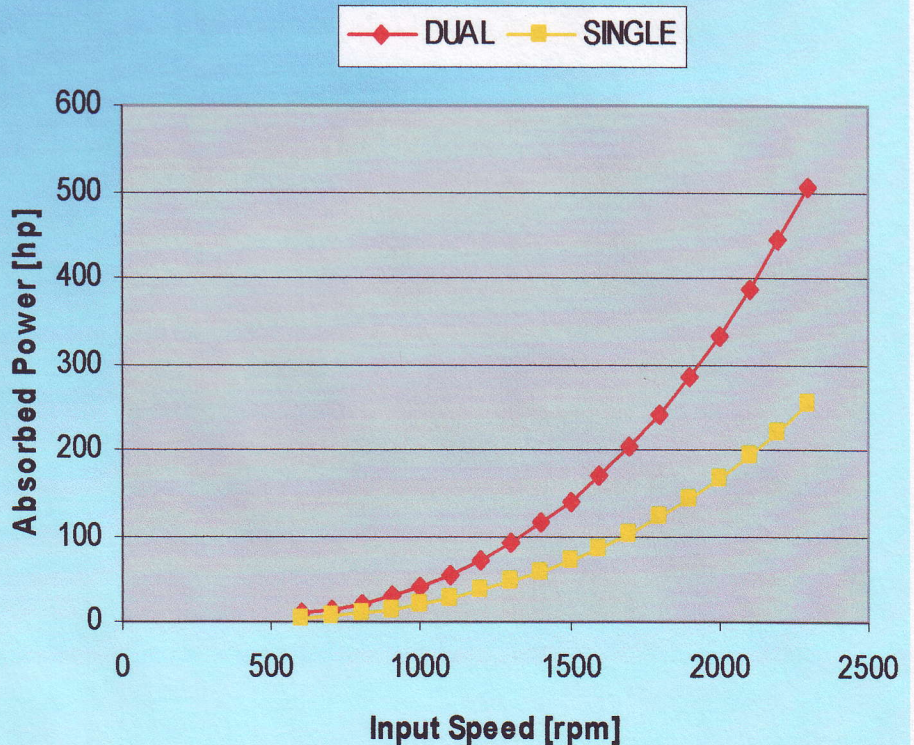

ISLAND CITY LLC

1800 West Taylor Street, Merrill Wisconsin USA 54452
TEL: 715 536 8600 FAX: 715 536 8660