

MULTI PIN DXN37C

Product Features



Locking Provision

For insertion of locking pin (or padlock) to prevent inadvertent disconnection

Stainless Steel Casing

Casings are stainless steel for maximum durability and protection.

Lid

Provides additional protection from harsh environments.

Silver-Nickel Contacts

Silver-nickel contact material provides superior conductivity, durability and corrosion resistance.

Recessed Contacts

Provides IP2X protection from live electrical parts.

Spring Loaded Butt-Style Contacts

Ensures optimal contact force and superior electrical performance over thousands of operations.

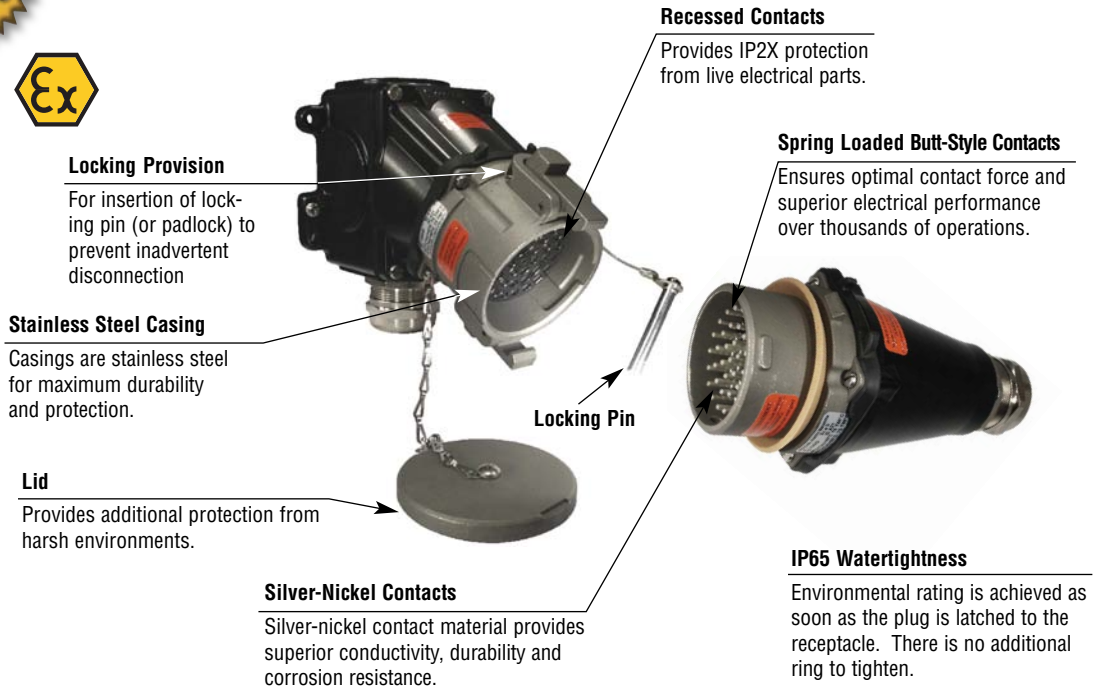

Hazardous Duty Listings

ATEX

II 2 G/D Ex e II tD A21 IP65
Suitable for Zone 1 & 2 (gas) 21 & 22 (dust)
(Dust certification is limited to particles > 75 µm)

-40 °C <Ta<+40 °C T6 T66 °C

-40 °C <Ta<+60 °C T5 T86 °C

Highlighted Feature

DXN37C Contact

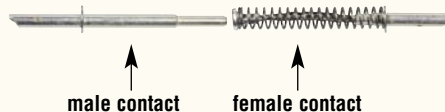

DXN37C devices feature silver-nickel, spring-loaded, butt-style contacts for superior durability and electrical performance. Terminals are solder type.

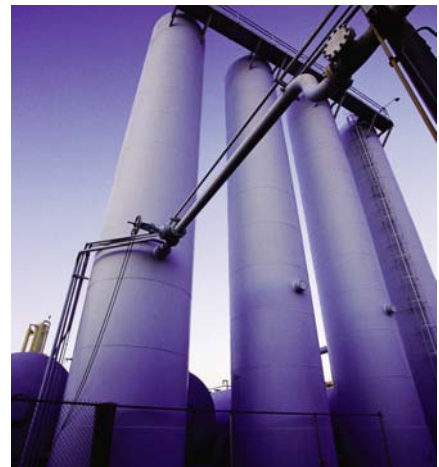

DXN37C Multipin – 5A Hazardous Duty Plugs & Receptacles

Connector
(female receptacle w/handle)



Receptacle w/angle (female) **or** **Receptacle/Angle/Box** (female)



Voltage	Polarity	Part # Metal	Part # Metal	Part # Metal
220V	36P+G	36-M3361-XXX	36-M7361	36-M0361-XXX

Plug
(male inlet w/handle)



Inlet w/angle (male) **or**



Inlet/Angle/Box (male)



Voltage	Polarity	Part # Metal	Part # Metal	Part # Metal
220V	36P+G	36-M1361-XXX	36-M9361	36-M6361-XXX

Ratings

- **Voltage**
220 VAC
- **Amperage Rating**
5A Not for disconnection of a live circuit
- **Environmental Ratings**
IP65
- **Temperature Range**
Min -40°F/Max 140°F
- **Wiring Capacity***
Min 16 AWG Max 14 AWG
* Based on THHN wiring connection type solder
- **Terminal Type**
Solder
- **Listings**
ATEX

XXX Suffix / Cable Range

XXX (Suffix #)	Cable Range (in)
-20M	.31 - .50
-25M	.35 - .63
-32M	.50 - .825

Dimensions Receptacle – Provided in inches and millimeters

Dimensions are for reference only

connector

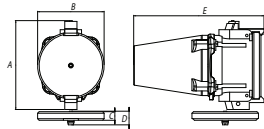

PRODUCT	A	B	C	D	E
DXN37C	4.49	3.35	.43	.71	6.57

plug

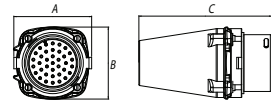

PRODUCT	A	B	C
DXN37C	3.43	3.19	5.83

receptacle / angle / junction box

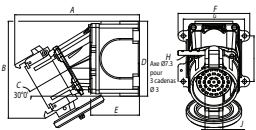

PRODUCT	A	B	C	D	E	F	G	H	I	J
DXN37C	7.52	5.87		4.53	2.95	4.33	3.7		2.76	1.06

receptacle / box + plug

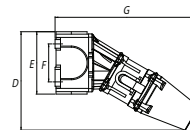

PRODUCT	A	B	C	D	E	F	G
DXN37C	4.49	4.33	3.70	7.13	4.53	2.76	10.43